



Caddy Assembly Instructions

To support ease of use and clear identification, collection supplies are now organized in a labeled storage caddy designed to improve workflow efficiency. The caddy accommodates swabs, pipettes, biohazard bags, original HealthTrack devices, the new Vaginitis and CGT swab kits, urine collection devices, and, if desired, billing cards and lab packs.

Once assembled, the caddy is designed to be flexible for counter space and may be positioned with either the long side or short side facing outward. Use the provided device stickers to label the caddy based on the orientation that best fits your workspace.



1. Fold short middle divider with t-tabs and place in the middle of the HealthTrack Caddy Body.

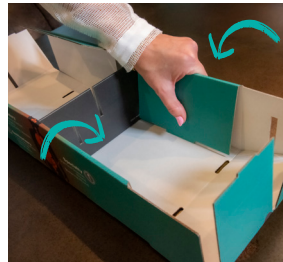

2. Fold side flaps up and over t-tabs to lock into place.



3. Fold long divider with t-tabs in half, align slots & slide down into short, middle divider slot.



4. Fold end flaps over t-tabs to lock into place.



5. Fold small divider in half, slide down into place and align tabs as indicated by the arrow.



6. Fold two small matching dividers in half and align tabs with slots as indicated by the arrow.



7. HealthTrack Caddy Box should look like this when assembled.

If your caddy came with stickers, you have two layout options based on where you want your caddy to sit in the clinic.

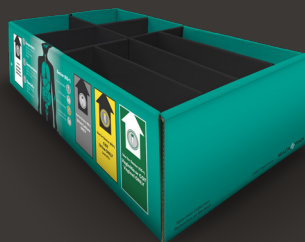

Horizontal Orientation — preferred
(long side facing out)



Vertical Orientation
(short side facing out)

Questions?

Please contact the Customer Service team or your local sales representative for more information at [866-287-3218](tel:866-287-3218).



Visit HealthTrack University at htrxu.com for testing resources.

Hours:

Monday – Friday: 7:00am – 7:00pm CT
Saturday: 8:30am – 5:00pm CT